

# 中空軸旋轉平台 Hollow Rotary Actuators



質量:2kg

**MD** 旋轉平台系列  
**60** 規格  
**R** 選配  
**5** 減速比  
**5A** 馬達類型

R: 直角轉向減速  
 F: 附馬達連座

V1: 伺服Ø8 PCD45,M3  
 V2: 伺服Ø8 PCD46,M4

T1: 步進Ø5 PCD43.8,M3  
 T2: 步進Ø6 PCD43.8,M3  
 5A: 齒步進馬達42H5K-2A

各廠牌100W AC 伺服馬達

各廠牌42型步進馬達

## 定位精度檢測 此規格定位精度僅以比例檢驗

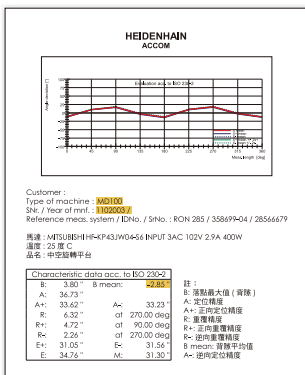

產品型號	MD60	MD60R
旋轉平台軸承	深溝滾珠+止推滾珠軸承	
容許轉矩N.m	5	
精度壽命	15000 Hrs	
允許轉速rpm	200 (盤面)	
減速比	5	15
重覆精度arc-sec	≤ 15	≤ 20
定位精度arc-min	≤ 1	≤ 1
旋轉平台平行度mm	≤ 0.02	
旋轉平台同心度mm	≤ 0.02	
保護等級	IP40	

P.S:圓周單位: 1 rpm = 360° 1°=60'(arc-min) 1'=60"(arc-sec)  
 圓周誤差換算直線誤差: 盤面直徑x 3.14159 ÷ (360°x60'x60") x背隙值

### 盤面同心度檢測

≤0.02mm

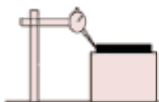

### 盤面旋轉振幅

≤0.02mm

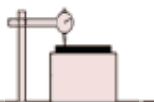

### 盤面與底座平行度

≤0.02mm

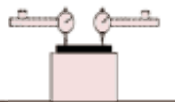

外徑任意點定位精度  
 半徑17.5mm  
 ≤1min

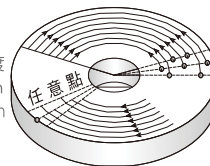

反覆定位精度  
 半徑17.5mm  
 ≤15 sec

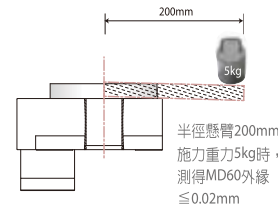



**MD60-5-5A**  
(此型號含步進42H5K-2A)

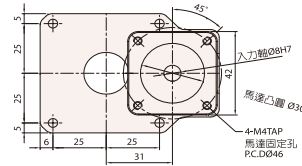
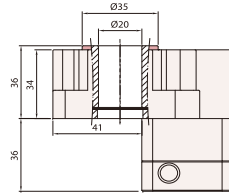
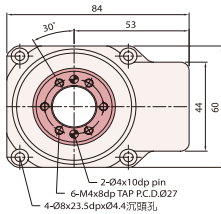
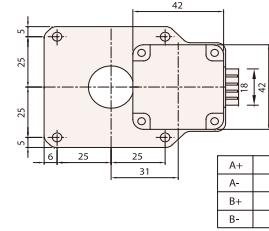
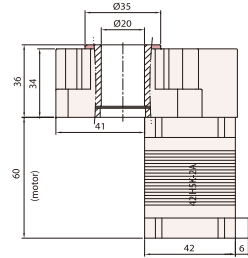
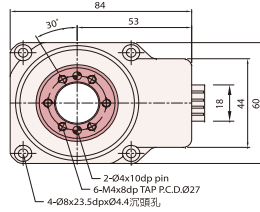

**MD60F-5**  
(附連結座可自行組裝馬達)



**MD60R-15**  
(直角轉向式 1:15)

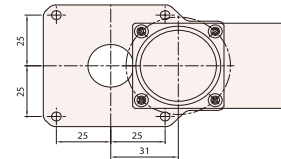
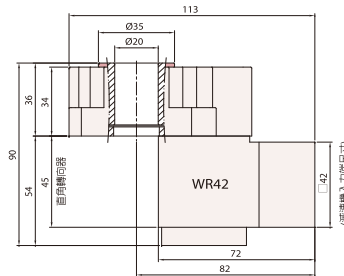
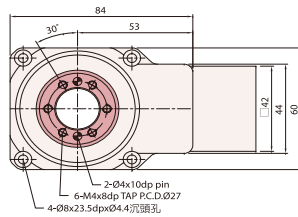

訂購時請提供馬達法蘭尺寸  
P.S:原點Sensor規格 (選配) OMRON EE-SX672