

HD

海波齒旋轉台

Hypoid Gear Drive

High precision Drive



重複精度

Repetitive precision

≤ 5 rev/sec

HD 多曲面螺旋驅動

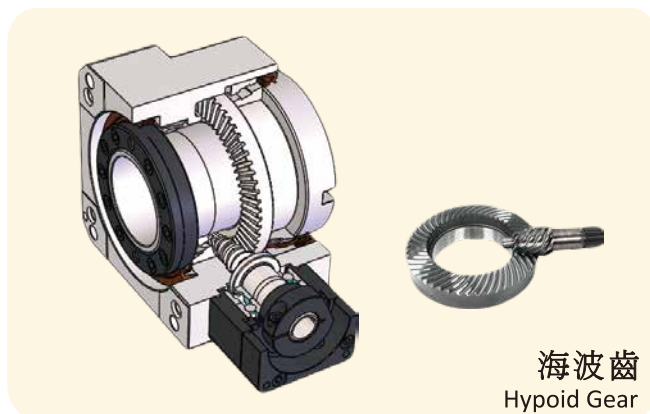

高精度旋轉定位 High-precision rotation positioning

海波齒又名戩齒輪，它是直交軸傳動，具螺旋狀的齒輪，它不同於螺旋傘型齒輪，它具備高減速比、高傳動效率、高轉矩、高精度、低磨耗的優點，傳動精度可達10角秒。

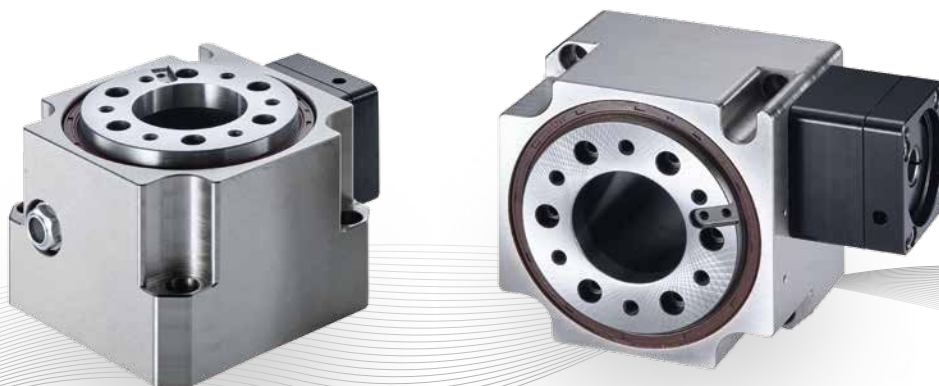

Feature
1

IP65防護 Protection
具防水等級
適用於濕式環境
Waterproof grade
Suitable for wet environments

Feature
3

高精度 High precision
齒輪達JIS 0 級要求(齒輪幾何公差 $\leq 0.002\text{mm}$)
超低背隙
Gear up to JIS 0 rating
(gear geometry tolerance $\leq 0.002\text{mm}$)Ultra low backlash

Feature
5

超低噪音 Ultra low noise
1500rpm運轉噪音值小於50dB
1500rpm running noise value is less than 50dB

Feature
2

高剛性·高扭矩 High rigidity · high torque
合金鋼外殼及大模數齒根設計
最適用於大慣量負載的旋轉需求
Alloy steel shell and large modulus tooth root design
Suitable for large inertial load rotation needs

Feature
4

高傳導效率 High conduction efficiency
齒輪以螺旋導程設計,以滑動方式轉動
傳動效率達96%
Gears designed with spiral lead, rotated in a sliding manner
Transmission efficiency up to 96%

Feature
6

壽命長 Long life
使用高硬度、高密度齒輪材料
精度壽命佳
Using high hardness, high density gear materials
with excellent life expectancy



■ 應用範例 Application

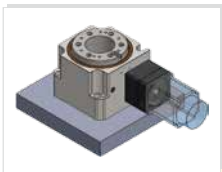

臥式安裝
Horizontal installation

HD 最適用於大盤徑、大慣量
需快速定位的旋轉用途

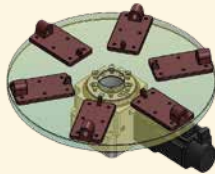

臥式安裝
Horizontal installation

馬達側向安裝，方便結合X-Y平台應用

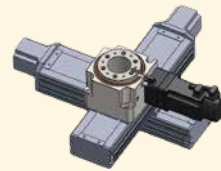

立式安裝
Vertical installation

可使用於側向懸臂旋轉

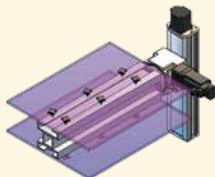

吊式安裝
Hanging installation

高剛性機殼及軸承設計
HD 具備高承重倒裝使用

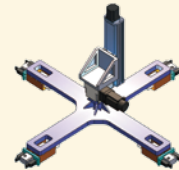

HD 100 - 30

V1



規格 Table size	減速比 Ratio	馬達規格 Motor type				
100 150 200	HD100	HD150				
V1 V2	400W 伺服馬達	V1 V2	750W 伺服馬達	HD200	V1 V2	1000W 伺服馬達
T1 T2 T3 T4 T5	60型 步進馬達	T1 T2	86型 步進馬達			

型號 / 規格 Model		HD100-30 □	HD150-30 □	HD200-30 □
容許轉矩 Max. torque	N·m	115	230	480
容許軸向載重 (Ka) Max. axial load	kg	250	600	1100
容許軸向力 (Fa) Max. axial force	N·m	200	400	700
容許徑向力 (Fr) Max. radial force	N·m	250	500	900
容許盤向轉速 Max. speed of table		540° / sec		360° / sec
減速比 Gear ratio	i	30:1		
定位精度 (絕對) Positioning precision	arc-sec	± 25	± 20	± 15
定位精度 (相對) Positioning precision	arc-sec	± 10	± 7	± 5
重複精度 Repetitive precision	arc-sec	≤ 8"	≤ 5"	≤ 5"
精度壽命 Lifetime of precision	hr	> 30000		
保護等級 Protection rating		IP65		
允許環境溫度 Temperature		-10°C ~ 60°C		
質量 Weight	kg	8.5	18.6	61

· 原點Sensor規格(選購) OMRON EE-SX672

盤面精度檢測 Positioning precision inspection

特別需求 Special request

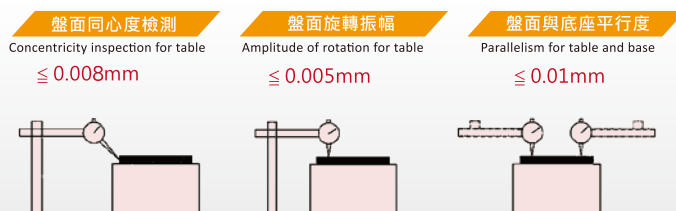

- ▲ 盤面同心度，可製作 $\leq 0.002\text{mm}$ 精度，請各別洽談
- ▲ 盤面旋轉振幅，可製作 $\leq 0.002\text{mm}$ 精度，請各別洽談
- ▲ 盤面平行度，可製作 $\leq 0.002\text{mm}$ 精度，請各別洽談

The customization of $\leq 0.002\text{mm}$ rotation amplitude / $\leq 0.002\text{mm}$ parallelism is also available. For special needs, please contact with us.

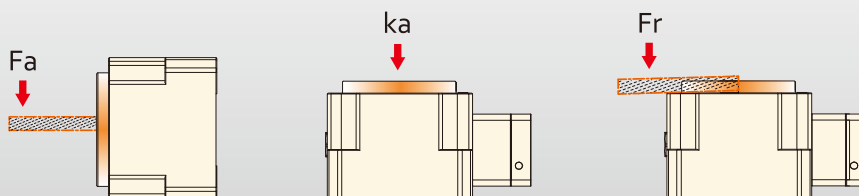

- HD100
- HD150
- HD200

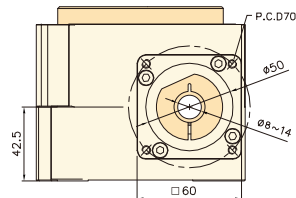
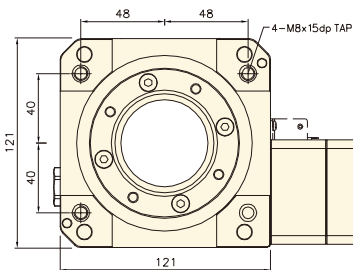
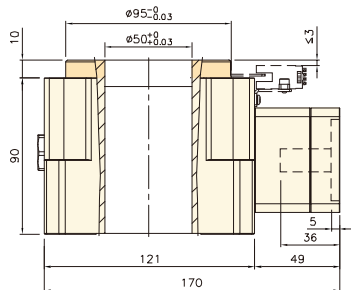
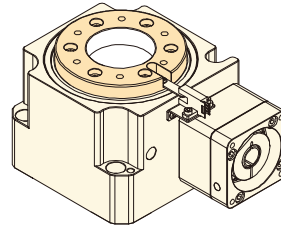
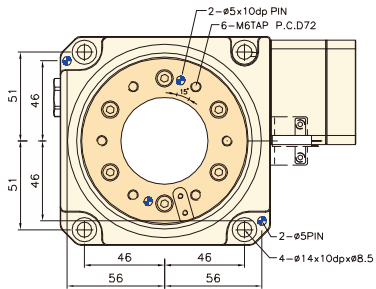

型號識別	
HD100-30V1	HD100-30T1
HD100-30V2	HD100-30T2
	HD100-30T3
	HD100-30T4
	HD100-30T5

馬達規格識別	
V1: Ø14-PCD70-M4	T1: Ø8-PCD66.67-M4
V2: Ø14-PCD70-M5	T2: Ø8-PCD70.71-M4
	T3: Ø10-PCD70.71-M4
	T4: Ø6.35-PCD66.67-M4
	T5: Ø8-PCD70.71-M5
400W伺服馬達	60型步進馬達

HD100

容許盤面載重250kg
Max. tableload 250kg

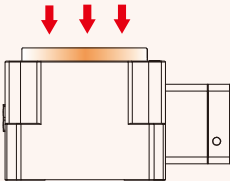

軸向載重
Axial load

200N

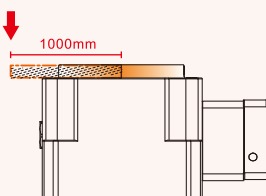

盤面平行度變形量 ≤ 0.002mm
Table parallelism deformation ≤ 0.002mm

300N

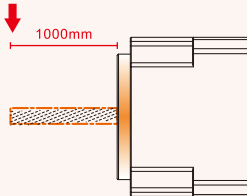

盤面平行度變形量 ≤ 0.002mm
Table parallelism deformation ≤ 0.002mm

軸向載重
Axial load

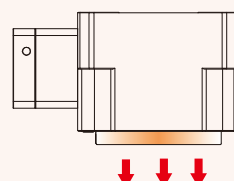

容許盤面吊重200kg
Max. tablehanging weight 200kg

- HD100
- HD150
- HD200

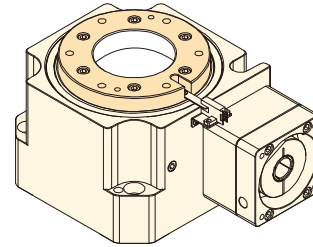
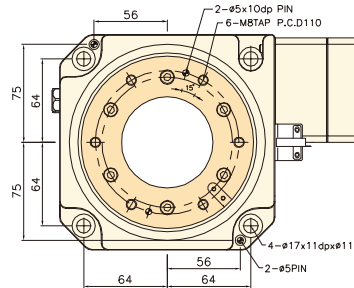

· 原點Sensor規格(選配) OMRON EE-SX672

型號識別

HD150-30V1	HD150-30T1
HD150-30V2	HD150-30T2

馬達規格識別

V1: Ø 19-PCD90-M5	T1: Ø 14-PCD98.4-M5
V2: Ø 19-PCD90-M6	T2: Ø 14-PCD98.4-M6
750W伺服馬達	86型步進馬達

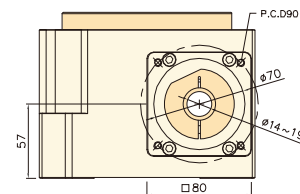
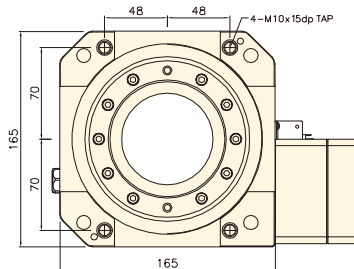
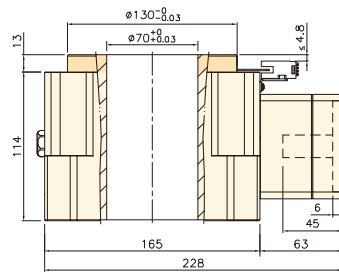

HD150

容許盤面載重600kg
Max. tableload 600kg

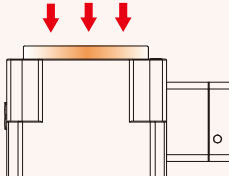

軸向載重
Axial load

550N

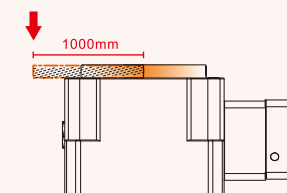

盤面平行度變形量 ≤ 0.002mm
Table parallelism deformation ≤ 0.002mm

800N

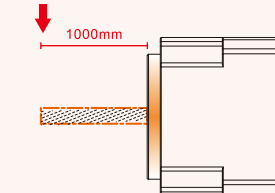

盤面平行度變形量 ≤ 0.002mm
Table parallelism deformation ≤ 0.002mm

軸向載重
Axial load

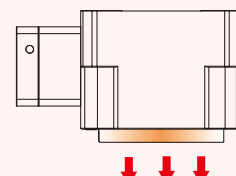

容許盤面吊重500kg
Max. tablehanging weight 500kg

- HD100
- HD150
- HD200

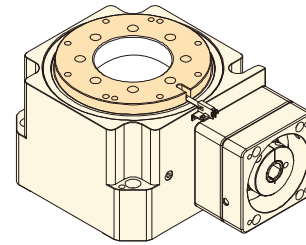
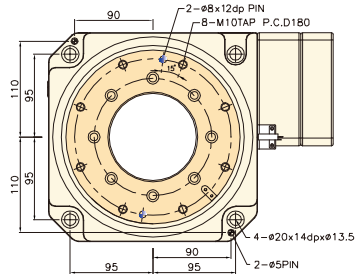

· 原點Sensor規格(選配) OMRON EE-SX672

型號識別

HD200-30V1
HD200-30V2

馬達規格識別

V1: Ø22-PCD145-M8
V2: Ø24-PCD145-M8
1000W伺服馬達

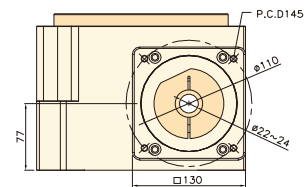
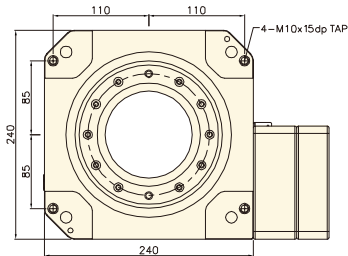
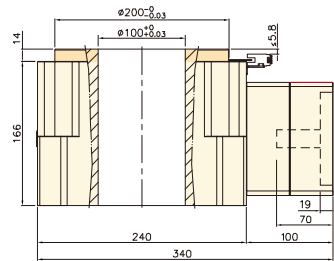

HD200

容許盤面載重1100kg
Max. tableload 1100kg

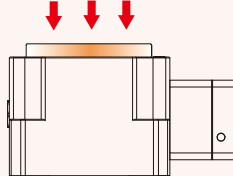

軸向載重
Axial load

1500N

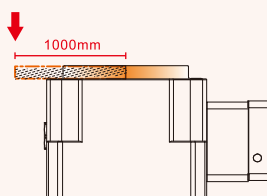

盤面平行度變形量 ≤ 0.002mm
Table parallelism deformation ≤ 0.002mm

2300N

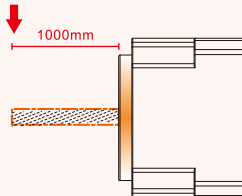

盤面平行度變形量 ≤ 0.002mm
Table parallelism deformation ≤ 0.002mm

軸向載重
Axial load

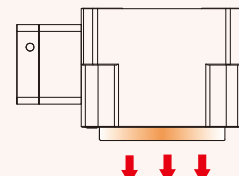

容許盤面吊重900kg
Max. tablehanging weight 900kg